

Bestückungsplan - *contact layout*

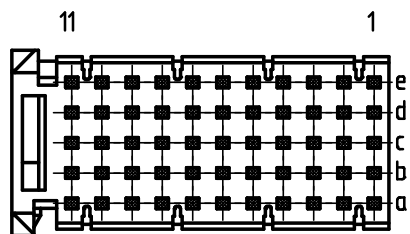

■ = bestückt - *assembled*

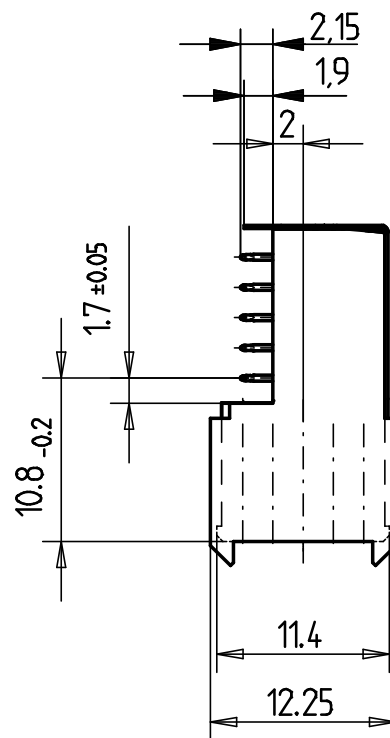
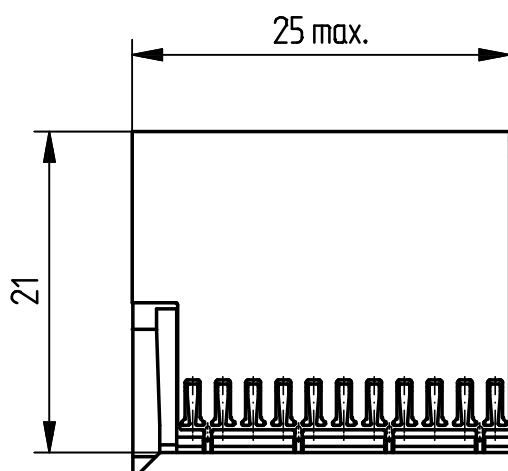
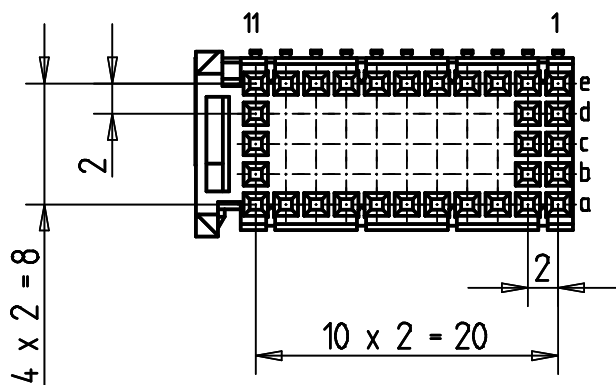

Lochbild für Leiterplatte  
(Bestückungsseite)

Board hole pattern  
(Component mounting side)

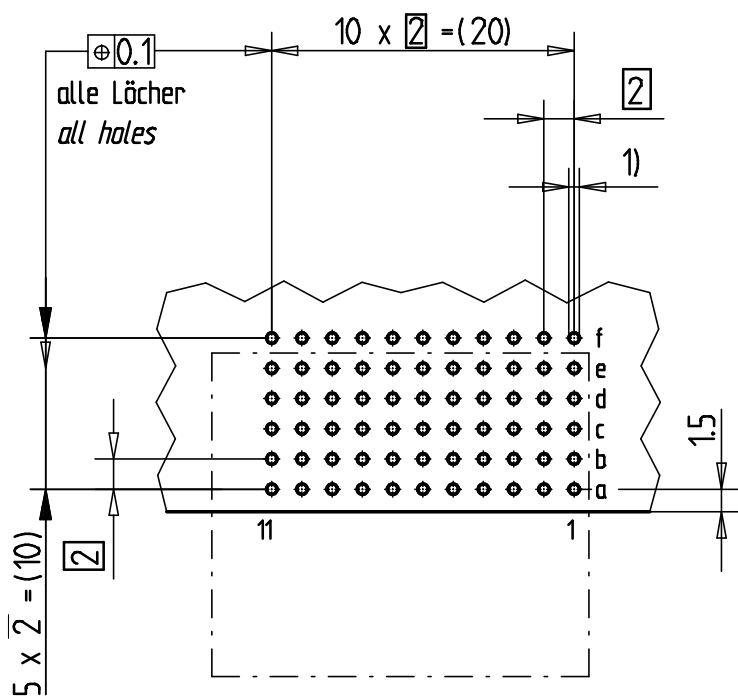

- 1)  $\varnothing 0.6 \pm 0.05$  Durchmesser des metallisierten Loches  
 $\varnothing 0.6 \pm 0.05$  Diameter of finished plated-through hole
- $\varnothing 0.7 \pm 0.02$  Bohrungsdurchmesser des Loches  
 $\varnothing 0.7 \pm 0.02$  Diameter of drilled hole

Schichtaufbau im metallisierten Loch  
siehe Zeichnung 114406

Metal plating of plated-through hole  
see drawing 114406

Fehlende Masse und Angaben nach IEC 61076-4-101  
Missing information and dimensions per IEC 61076-4-101

Information: ohne Fixierstift - <i>without locating pegs</i> Abschirmblech oben montiert <i>shielding mounted on top</i>	Tolerances		Scale	2:1
	All rights reserved. Only for information. To insure that this is the latest version of this drawing, please contact one of the ERNI companies before using.		Designation ERmet Federl. C THT ERmet Female Type C THT	
Consider protection memo from DIN 34	Subject to modification without prior notice. Drawing will not be updated.	All Dimensions in mm	100800760004	
b Index	31.08.2009 Date	ERNI www.ERNI.com	K	
V:00068374.SZA		ERMC		